



PEACE, HEALTH & HUMAN DEVELOPMENT  
公益財団法人 PHD 協会



SINCE 2020

# MINNANOIE

INTERNATIONAL COOPERATION • JOINT SHAREHOUSE

Live Together ~ Diversity & Inclusion ! ~

At the PHD Association, we provide residence support programs for foreigners who are in need due to various circumstances to help rebuild their lives.



Support with Learning Japanese



Food Support



Employment and Further Education Support



Accomplishments

• As of the end of March 2023

16

Nations and regions

343

People

1,436

Total Cases

Support with paperwork and obtaining Visa



居住支援法人 (兵居支第0015号)  
登録支援機関 (21登-006125)



Total housing capacity of 9 people.

At the PHD Association, we work to culturally connect Japanese people and foreigners.

We hold food distribution events!

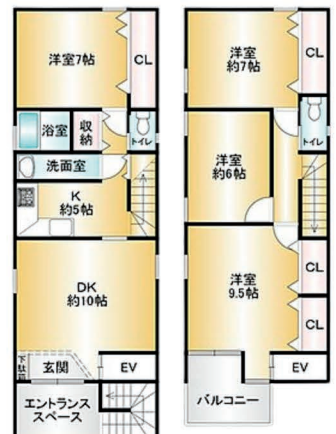



# Monthly Supporters Recruiting



The monthly donation of 1,000 yen per month to Minnanoie supports the independence of foreigners living in Japan!



- Utility
- Food Expenses
- Medical products
- Toiletries
- Furniture · Home Appliances
- ...etc.



## One of Our Cases 《Indonesian Man》

**2017** Arrived to Japan as a technical intern trainee. Worked in mechanics, but changed to working in animal husbandry. While working in animal husbandry, he did not receive salary for 2 months. As a result, was forced to return to Indonesia.

**2022** He returned to Japan with a Specific Skilled Worker Visa and worked in animal husbandry in Hokkaido. Lived in extremely cold conditions in a shed with no toilet or heat. Employers ignored the unreasonable living conditions and other difficulties. Employers told him to return to Indonesia, but escaped the job and stayed in Japan instead.

**2023** Sought refuge at PHD Association's Minnanoie. As a Registered Support Organization, PHD:  
-Introduced him to a job as a nursing caregiver.  
-Taught him Japanese.  
-Helped gain status of residency and completing administrative paperwork.

**now** Received another Specific Skilled Worker Visa in nursing and now works in a skilled nursing facility for elders.

I had many difficulties. I almost felt like I wanted to die. While I was escaping, I met the people at PHD, and they helped me with many of my challenges. They helped me apply for a specified skilled worker visa and introduced me to job opportunities. The people at PHD are like family to me. I will never forget them.

### A message from our resident



Webサイトから約3分で寄付のお手続きが完了します

1 「PHD協会」と検索  
PHD協会のHPへ!

2 「入金・寄付」を  
クリック!

3 「みんなのいえ」  
マンスリーサポーター  
カードマークをクリック!

登録完了!



- ✓毎月、自動引落し
- ✓ご寄付は寄付金控除の対象
- ✓月1回「みんなのいえ」便りをお届けします
- ✓会報（年3回）と事業報告書をお届けします

QRコードからも登録できます!



## PHD協会へのご寄付は寄付金控除の対象です。

PHD協会は、内閣府より「公益財団法人」としての認定を受けています。

これにより、支援者の皆様（個人・法人）からの寄付金については、特定寄付金として、一定の条件下、税制上の優遇措置が受けられるようになります。個人様からのご寄付の場合、最大約5割が控除されることもあります。



### Information

〒653-0836  
3-7-4Kagura town, Nagata ward, Kobe city, Hyogo  
Tel:078-414-7750 Fax:078-414-7611 Mail:info@phd-kobe.org



Scan QR code